



MF106 High Protection Peristaltic Pump

Lead Fluid MF106 high-protection peristaltic pump, designed and developed for pharmaceutical and industrial applications. With IP66/IP67 high protection level, it possesses dust-proof and short-term liquid immersion capabilities, enabling stable operation in harsh environments such as dust, humidity, weak acid and alkali, and salt spray for extended periods.

Feature

- Precision-crafted cast aluminum shell

Streamlined appearance, lightweight cast aluminum powder-coated shell, excellent heat dissipation, strong corrosion resistance.

- Integrated structure, great integrity

The pump head and the driver are integrated, easy installation.

- Seven-inch large screen, clear at a glance

A seven-inch color LCD touch screen with wide viewing angles, making operation simple.

- Servo motor drive

High-precision operation, high torque, low noise.

- Five working modes

Offers flow mode, volume mode, time dispensing mode, programming mode, and external control mode, flexibly meeting various scenario requirements.

- Intelligent interconnection, collaborative operation

Supports RS485 communication, compatible with Modbus protocol.

- Three-level user permission management, security protection, no need to worry about parameter tampering.

- Selects top-brand raw materials, meticulously selected, quality guaranteed.

Technical Parameter

Parameter	MF106
Flow range	0.006-7800mL/min
Speed range	0.1-360 rpm
Speed resolution	0.1rpm,accuracy 0.2%
Speed accuracy	< 0.5%
Work mode	Key control start and stop, direction, full speed, state memory (power-off memory). Foot switch control, external control start/stop and direction, with physical isolation, 5V/12V 24V level input optional, 0-5V/ 0-10V/4-20mA adjustable speed optional, flow mode, volume dispensing mode, time dispensing mode
Adjust method	Touch screen operation
Display method	5-inch color touch screen
Rotating direction	CW/CCW
External control signal input	(1) Start/Stop: passive contact, external control input level (5~24V) (2) Forward/Reverse: passive contact, external control input level (5~24V) (3) Speed Regulation: analog 0~5V, 0~10V, 4~20mA can be set.
External control signal output	(1) Start/Stop: Level Signal (following input voltage) (2) Forward/Reverse: Level Signal (following input voltage)
Communication interface	RS485 communication interface, Modbus protocol is available
Power supply	AC 100-240V 50-60 Hz
Power consumption	<180W
Working environment	Working temperature 0-40°C, working humidity 80%
Shell material	Aluminum
IP grade	IP66/IP67
Dimension (L×W×H)	363×180×230mm
Drive weight	11kg

MF106 Applicable Pump Head and Tube, Speed, Flow

Drive Type	Pump Head	Channel	Tube	Single Channel Flow Rate (mL/min)
MF106	YZ15/YZ15T	1,2,4	13#14#19#16#25#17#18#	0.006 ~ 1537
	YT25	1,2	114#116#15#24#35#36#	0.024 ~ 1800
	KZ25	1	15#24#35#36#	0.31 ~ 3960
	DMD25	1	114#119#116#15#24#35#36#	0.058 ~ 4320
	YZ35	1	73#82#	1.3 ~ 7920

Above flow parameters are obtained by using silicone tube to transfer pure water under normal temperature and pressure, in actually using it is effected by specific factors such as pressure, medium etc. Above for reference only.

Dimension(mm)

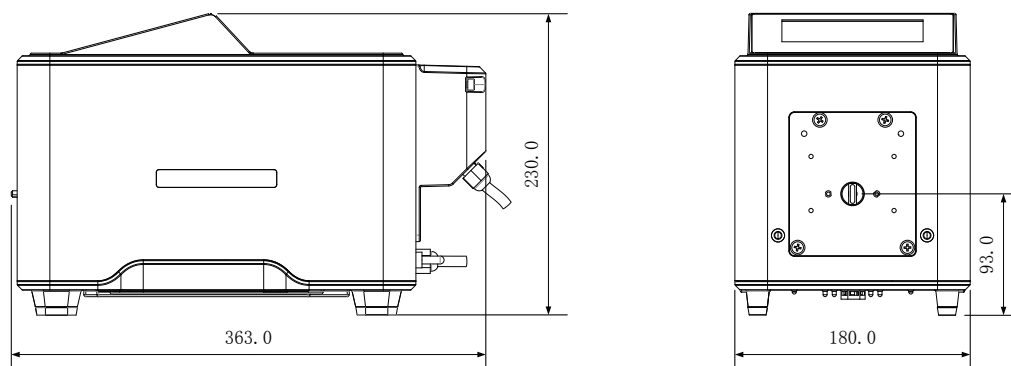

Statement: The final explanation right of above information belongs to Lead Fluid.